

POLYZORBE POLYESTER ACOUSTIC PANELS

DIRECT ATTACH INSTRUCTIONS

RECEIVING AND HANDLING

Panels should be stored in a dry/controlled area. Handle the acoustic panels carefully to avoid damage to the face or the edges. Do not twist or bow the panels during installation.

INSTALLATION TOOLS

- Electric drill or screwdriver
- Screws or other anchors and fasteners appropriate for mounting surface
- Table saw with PolyZorbe blade, band saw with plastic blade, sharp utility knife (if cutting required)
- 48" Drywall T-square
- Level

HOW TO INSTALL

- 1 We recommend painting the walls or ceilings black at the perimeter to help conceal the expansion joints at the edges of the wall or ceiling system.
- 2 Be careful when cutting and fitting around windows, light switches, and other penetrations.
- 3 Measure and mark the distance on the top and one side of the panel where it is to be placed on the wall or ceiling.
- 4 Make a horizontal and vertical line so they intersect to form a corner. A level is recommended.
- 5 Align the panel to the install location on the wall or ceiling, and then screw the panel to the wall or ceiling using anchors or fasteners appropriate for the mounting surface.
- 6 Screws should be placed a minimum of 0.75" from the edges of the panel.
- 7 For a finished look, washers may be used with pan head screws.

(CONTINUED ON NEXT PAGE)

WALL INSTALLATION

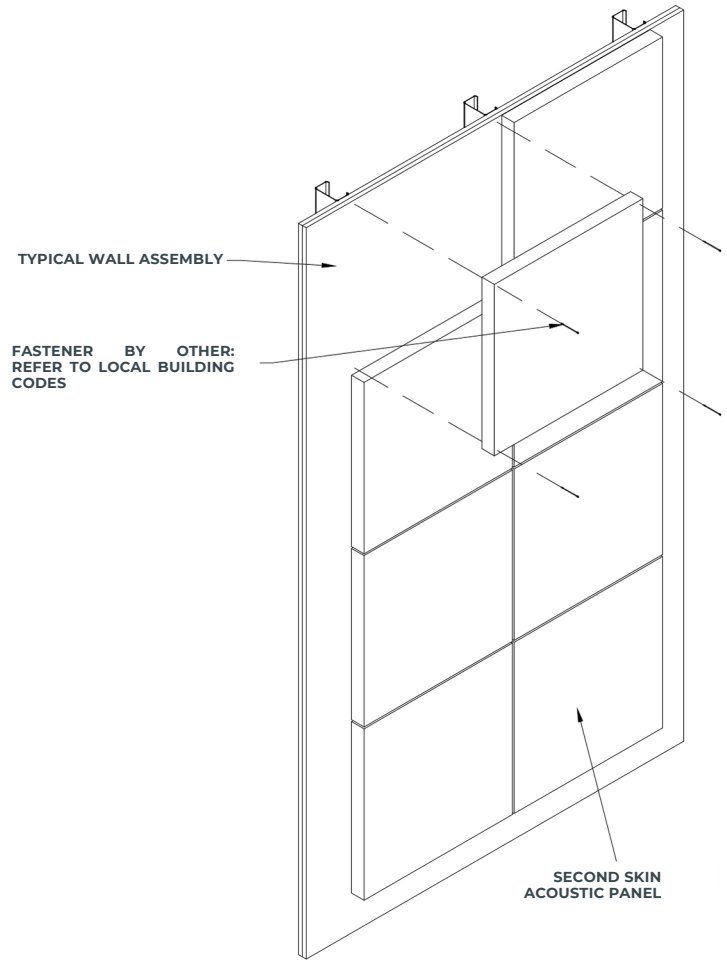

CEILING INSTALLATION

